



PSL-24200 25.6V 22.0 AH

Rechargeable Lithium Iron Phosphate Battery
PSL – LiFePO4 Series

PCM FEATURES

- Balancing function for cells
- Over-current protection
- Over-voltage protection
- Over-discharge protection
- Short-circuit protection

APPROVALS

- ISO9001:2015 – Quality management systems
- CE Certified
- UL 2054 Certified
- IEC 62133 Certified
- FCC Approved

TERMINALS: (mm)

M6 threaded insert
(female-threaded)

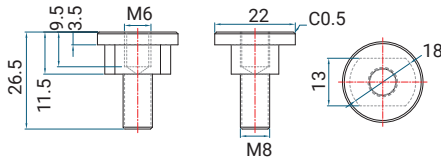

DIMENSIONS: inch (mm)



L: 7.70 (195)
W: 5.20 (130)
H: 7.20 (183)
HT: 7.20 (183)
T: 5.51 (140)

Tolerances are +/- 0.04 in. (+/- 1mm) and +/- 0.08 in. (+/- 2mm) for height dimensions. All data subject to change without notice.

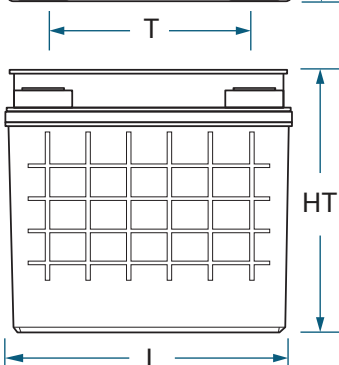

GLOBAL HEADQUARTERS (USA AND INTERNATIONAL EXCLUDING EMEA)

Power-Sonic Corporation
365 Cabela Dr Suite 300,
Reno, Nevada 89523
USA
T: +1 619 661 2020
E: customer-service@power-sonic.com

POWER-SONIC EMEA (EMEA – EUROPE, MIDDLE EAST AND AFRICA)

Smitspol 4, 3861 RS Nijkerk,
The Netherlands
T NL: + 31 33 7410 700
T UK: + 44 1268 560 686
T FR: + 33 344 32 18 17
E: salesEMEA@power-sonic.com

BATTERY FEATURES

- Compact and only 40% of the weight of comparable lead acid batteries
- Up to 10 times more cycles than lead acid batteries
- Faster charging and lower self-discharge
- Delivers twice the power of lead acid batteries, even high discharge rate, while maintaining high energy capacity
- Super safe chemistry reducing the risk of explosion or combustion due to high impact, over-charging or short circuit situation
- Rugged impact resistant ABS case and cover flame retardant to UL94:V0

PERFORMANCE SPECIFICATIONS

Nominal Voltage	25.6 volts
Rated Capacity	22.0 AH
Watt Hour	563
Life Expectation	Residual capacity is approximately 60% of rated capacity after 2500 cycle based on standard charge/discharge
Approximate Weight	13.0 lbs. (5.9 kg)
Cell Configuration	IFR 18650EC - 1.5AH 8S15P
Internal Resistance at 50% SOC	<60.0 milliohms
Max Continuous Discharge Current at 68°F (20°C)	16A
Protection/Communication	PCM
Shelf Life (% of nominal capacity at 68°F (20°C))	
1 Month	97%
3 Month	91%
6 Month	85%
Operating Temperature Range	
Charge	32°F (0°C) to 122°F (50°C)
Discharge	14°F (-10°C) to 122°F (50°C)
Storage	32°F (0°C) to 86°F (30°C)
Case	Flame Retardant ABS Plastic UL94:V-0
Power Sonic Chargers	Contact us for information on a suitable charger
Standard Charge/Discharge	
Constant Current Charge Voltage	Charge CC@0.2C to 14.6V then CV until current drops to 0.05C; Rest 30 min.
Maximum Charging Current	10A
Charging Time with Max Charging Current	2.5 Hours
Standard Discharge	Discharge @ 0.2C to 10V.
Terminal	M6 threaded insert (female-threaded)

CAPACITY OF LiFePO4 vs. LEAD ACID AT VARIOUS CURRENTS OF DISCHARGE

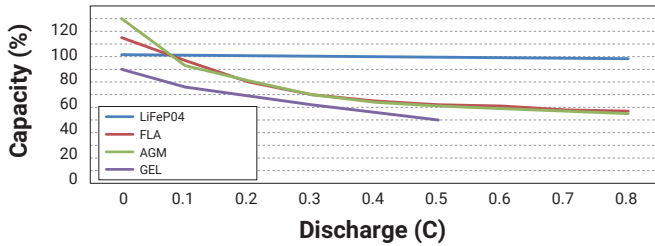

DISCHARGE VOLTAGE PROFILES AT VARIOUS RATES 25°C AMBIENT TEMPERATURE

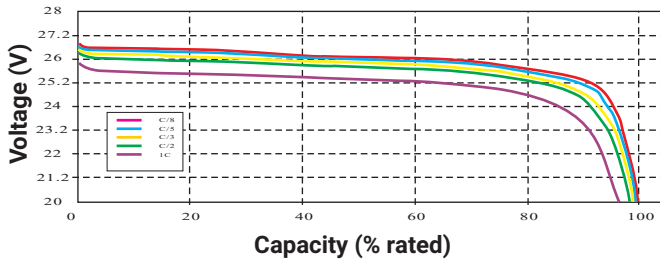

DISCHARGE VOLTAGE PROFILES AT 0.5C DISCHARGE RATE VARIOUS AMBIENT TEMPERATURES

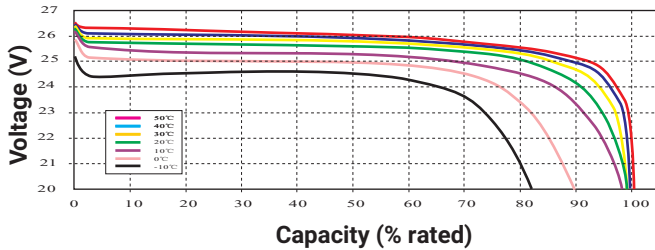

CYCLE LIFE vs. VARIOUS TEMPERATURE 0.2C CHARGE/0.5C DISCHARGE @ 100% DOD

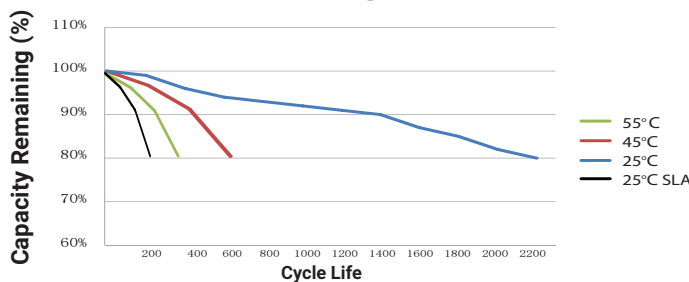

CHARGING CHARACTERISTICS (0.2C AMP @ 25°C)

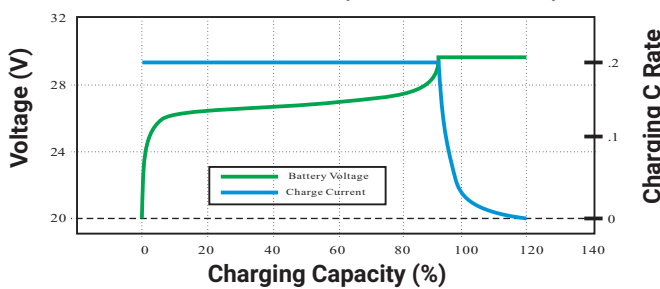

GLOBAL HEADQUARTERS (USA AND INTERNATIONAL EXCLUDING EMEA)

Power-Sonic Corporation
 365 Cabela Dr Suite 300,
 Reno, Nevada 89523
 USA
 T: +1 619 661 2020
 E: customer-service@power-sonic.com

POWER-SONIC EMEA (EMEA – EUROPE, MIDDLE EAST AND AFRICA)

Smitspol 4, 3861 RS Nijkerk,
 The Netherlands
 T NL: + 31 33 7410 700
 T UK: + 44 1268 560 686
 T FR: + 33 344 32 18 17
 E: salesEMEA@power-sonic.com

PSL-24200 25.6V 22.0 AH

Rechargeable Lithium Iron Phosphate Battery
 PSL – LiFePO4 Series

APPLICATIONS

- Medical
- Solar
- Wind
- Mobility
- Data Center
- Transport
- Sports & Recreation
- Utility

CHARGERS

Power Sonic offers a wide range of chargers suitable for batteries with a variety of capacities.

Please refer to our website for more information on our switch mode and transformer type chargers.

Please contact our technical department for advice if you have difficulty in locating a suitable charger.

FURTHER INFORMATION

Please refer to our website www.power-sonic.com for a complete range of useful downloads, such as product catalogs, material safety data sheets (MSDS), ISO certification, etc.

