

Bubble

All-purpose Portable Camping Lantern

- Candle Mode Available
- Touch Switch Design
- 3 Brightness Levels



Worldwide Warranty Service

Model number

Date of purchase

Serial number

Store Stamp

This is the certificate of authenticity if this item and we confirm that it has been subjected to the most exacting quality controls by SYSMAX Innovations Co., Ltd.

NOTE:

Please ensure this warranty card is fully completed by the distributor or retailer after purchasing the product. Should the product fail to operate correctly during the warranty period, it may be returned with the completed warranty card and original sales receipt to the retailer or local distributor for replacement or repair.

Customer Service Email: service@nitecore.com

Features

- All-purpose portable camping lantern
- Equipped with 4 high CRI LEDs (CRI>90, Color Temperature: 2,700K) to produce a max output of 100 lumens
- 3 brightness levels and Candle Mode available
- Touch switch design
- Portable magnetic loop design
- Made from durable PC material
- Silicone shade is able to soften the light
- Waterproof and dustproof rating in accordance with IPX4

Specifications

Dimensions: ø72mm x 132mm (ø2.83" x 5.20")
Weight: 106g (3.74 oz) (Batteries Included)
 71g (2.50 oz)

Accessories

3 x AAA Batteries

Battery Options

	Type	Nominal Voltage	Compatibility
NITECORE HLB1300 Rechargeable Li-ion Battery Pack	—	3.7V	Y (Recommended)
Primary Alkaline Battery	AAA	1.5V	Y (Recommended)
Rechargeable Ni-MH Battery	AAA	1.2V	Y (Recommended)
Rechargeable LFP Battery	10400	3.2V	N (Incompatible)
Rechargeable Li-ion Battery	10400	3.7V	N (Incompatible)

Technical Data

Brightness Levels / Mode	HIGH	MID	LOW	Candle Mode
Brightness	100 Lumens	40 Lumens	6 Lumens	100 – 120 Lumens
Runtime	5h	10h	42h	5h

Note: The stated data is measured using 3 x 1.5V AAA alkaline batteries under laboratory conditions. The data may vary in real world use due to different battery usage or environmental conditions.

Usage Options

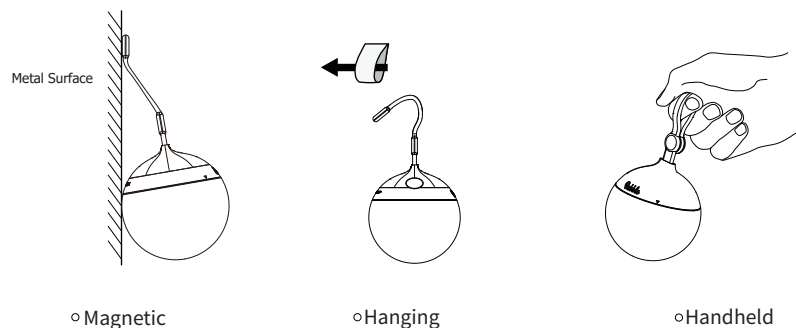

○Magnetic

○Hanging

○Handheld

Product View

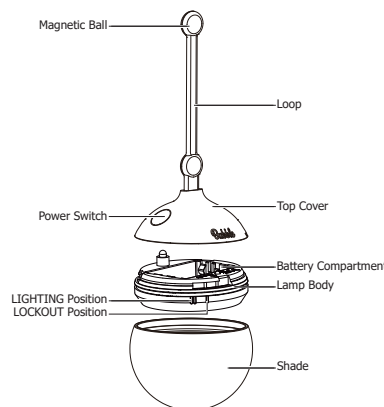

Operating Instructions

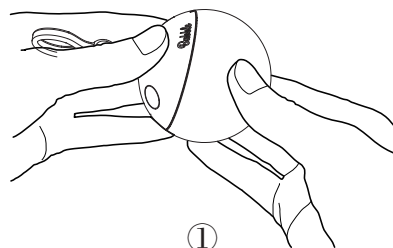

①



②

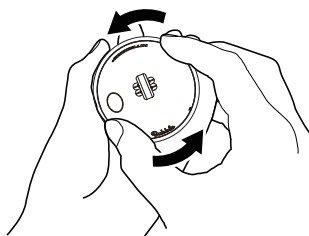

③

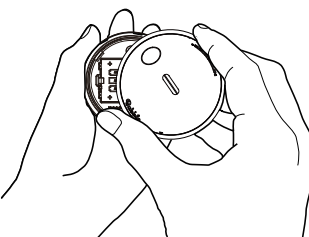

④

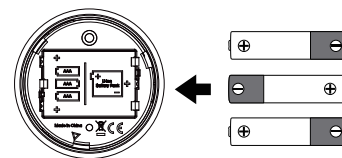

⑤

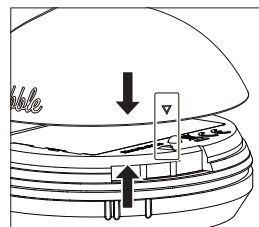

⑥

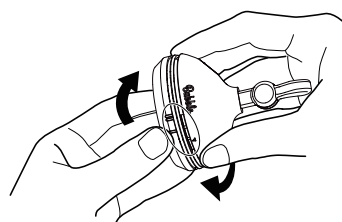

⑦

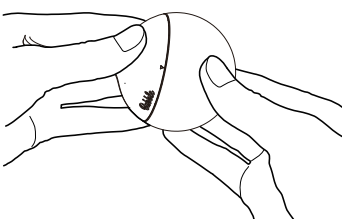

⑧

Lockout / Unlock

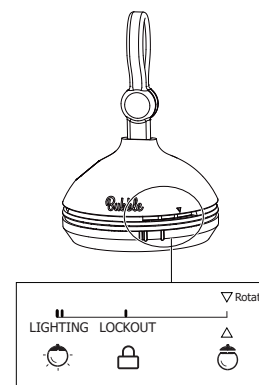

Warranty Service

All NITECORE® products are warranted for quality. Any DOA / defective product can be exchanged for a replacement through a local distributor/dealer within 15 days of purchase. After that, all defective / malfunctioning NITECORE® products can be repaired free of charge within 60 months from the date of purchase. Beyond 60 months, a limited warranty applies, covering the cost of labor and maintenance, but not the cost of accessories or replacement parts.

The warranty will be nullified if

1. the product(s) is/are broken down, reconstructed and/or modified by unauthorized parties;
2. the product(s) is/are damaged due to improper use.

For the latest information on NITECORE® products and services, please contact a local NITECORE® distributor or send an email to service@nitecore.com.

※ All images, texts and statements specified herein this user manual are for reference purposes only. Should any discrepancy occur between this manual and information specified on www.nitecore.com, Sysmax Innovations Co., Ltd. reserves the rights to interpret and amend the content of this document at any time without prior notice.

(English)

Operating Instructions

Battery Installation / Removal

1. Remove the Shade.
2. Hold the Bubble in your hand.
3. Rotate the Top Cover counterclockwise to the end.
4. Separate the Top Cover and the Lamp Body.
5. As illustrated, insert / remove the batteries according to the polarity labels.
6. Place the Top Cover over the Lamp Body according to the position of Δ.
7. Rotate the Top Cover clockwise to the LIGHTING Position to access Lighting Mode.
8. Install the Shade to complete the installation.

On / Off

- In Lockout Mode, rotate the Top Cover clockwise to the LIGHTING Position to access LOW.
- In Lighting Mode, touch and hold the Power Switch for 1 second to turn on / off the Bubble.
- When the light is on, rotate the Top Cover counterclockwise to the LOCKOUT Position to turn off the Bubble and access Lockout Mode.

Brightness Adjustment

When the light is on, touch the Power Switch to cycle through the following sequences: LOW – MID – HIGH – Candle Mode.

Lockout / Unlock

- **Lockout:** In Lighting Mode, press and rotate the Top Cover counterclockwise to the LOCKOUT Position to turn off the Bubble and access Lockout Mode. Lighting Mode is not available when the Bubble is locked.
- **Unlock:** In Lockout Mode, press and rotate the Top Cover clockwise to the LIGHTING Position to unlock the Bubble and access LOW.

Warnings

1. CAUTION! Possible dangerous radiation! Don't look into the light! May be dangerous for your eyes.
2. Remove all batteries when the product is left unused for a prolonged time.
3. When the product is kept in the backpack, please activate the Lockout Mode to prevent accidental activation.
4. DO NOT disassemble or modify the product as doing so will cause damage to it and render the product warranty invalid. Please refer to the warranty section in the manual for complete warranty information.
5. DO NOT immerse the product in water.
6. DO NOT install the batteries with wet hands.
7. DO NOT place the product close to the fire to avoid accidents and damage to the product.
8. Dispose of the device/batteries in accordance with applicable local laws and regulations.

(Français)

Instructions d'utilisation

Installation et retrait de la batterie

1. Retirer l'abat-jour.
2. Tenez la Bubble dans votre main.
3. Tournez le couvercle supérieur dans le sens inverse des aiguilles d'une montre jusqu'au bout.
4. Séparez le couvercle supérieur et le corps de la lampe.
5. Comme illustré, insérez / retirez les piles en respectant les étiquettes de polarité.
6. Placez le couvercle supérieur sur le corps de la lampe en respectant la position Δ.
7. Tournez le couvercle supérieur dans le sens des aiguilles d'une montre jusqu'à la position LIGHTING pour accéder au mode d'éclairage.
8. Installer l'abat-jour pour terminer l'installation.

On / Off

- En mode verrouillage, tournez le couvercle supérieur dans le sens des aiguilles d'une montre jusqu'à la position LIGHTING pour accéder au mode BAS.
- En mode éclairage, touchez et maintenez l'interrupteur d'alimentation pendant 1 seconde pour allumer/éteindre la Bubble.
- Lorsque la lumière est allumée, tournez le couvercle supérieur dans le sens inverse des aiguilles d'une montre jusqu'à la position LOCKOUT pour éteindre la Bubble et accéder au mode verrouillage.

Réglage de la luminosité

Lorsque la lumière est allumée, appuyez sur l'interrupteur d'alimentation pour faire défiler les séquences suivantes : BAS - MOYEN - HAUT - Mode Bougie.

Verrouillage / Déverrouillage

- **Verrouillage :** En mode éclairage, appuyez sur le couvercle supérieur et tournez-le dans le sens inverse des aiguilles d'une montre jusqu'à la position LOCKOUT pour éteindre la Bubble et accéder au mode verrouillage. Le mode éclairage n'est pas disponible lorsque la Bubble est verrouillée.
- **Déverrouillage :** En mode verrouillage, appuyez sur le couvercle supérieur et tournez-le dans le sens des aiguilles d'une montre jusqu'à la position ÉCLAIRAGE pour déverrouiller la Bubble et accéder au mode BAS.

Avertissements

1. ATTENTION ! Risque de radiation dangereuse ! Ne regardez pas la lumière ! Peut être dangereux pour les yeux.
2. Retirez toutes les piles lorsque le produit n'est pas utilisé pendant une période prolongée.
3. Lorsque le produit est rangé dans le sac à dos, activez le mode verrouillage pour éviter toute activation accidentelle.
4. NE PAS démonter ou modifier le produit, car cela l'endommagerait et rendrait la garantie du produit invalide. Veuillez vous référer à la section garantie du manuel pour des informations complètes sur la garantie.
5. NE PAS immerger le produit dans l'eau.
6. NE PAS installer les piles avec des mains mouillées.
7. NE PAS placer le produit à proximité du feu afin d'éviter les accidents et les dommages au produit.
8. Jetez l'appareil/les piles conformément aux lois et réglementations locales en vigueur.

