

M30R
USER MANUAL

M30R is a tactical and normal illumination combined , high-output max 1800lumen, 328 meter beam distance LED flashlight, holds a CREE XHP35 HD LED, powered by 1*18650 rechargeable battery, owns 4 illumination modes(Turbo-High-Medium-Low) and Strobe, SOS tactical function, 3 switches in tail cap to trigger the strobe and turbo modes in one step, owns power detection and location beacon built In , OTG power outlet as a portable bank for cell phones, designated for law enforcement, police , the military, the security officer and so on.

Caution

- Turn on in "strobe" mode may cause seizure in persons with photosensitive epilepsy.
- When operated for a long time, it will get uncomfortably warm. This is NORMAL and is not a defect.
- Do not use 16340 battery for this model.

Features

- CREE XHP35 HD LED, 50,000h life span
- 4 switches tactical illumination modes Included
- Any time, tail cap tactical switches operates priority, one step action to shoot target
- Tail cap tactical switch lock function
- New FCD rechargeable & chargeable function
- Integrated aluminum housing design assure LOGO and patterns in line
- Smart temperature control system
- Smooth brightness mode change

- Harmony breathing blink beacon
- Battery detection
- Low battery Indication
- Constant current circuit without flicker
- High-strength aerospace aluminum body, Mil-Spec hard anodized for extreme durability
- Coated tempered resists impact glass In high light transmittance
- Metal filmed reflector to create a high intensity beam

ANSI Chart

FL 1 STANDARD	TURBO	HIGH	MEDIUM	LOW	STROBE	SOS
OUTPUT	1800LM	460LM	130LM	20LM	1800LM	460LM
RUNTIME	40min	3.5h	13h	120h		
INTENSITY	26,300cd					
DISTANCE	328m(Max)					
WATERPROOF	IPX-8					
IMPACT RESISTANCE	2m					

The above running time data tested on the Fitorch lab In regular ambient temperature, use 1*18650 3400mAh Li-on rechargeable battery, different batteries may get tolerance data when compares with it.

Specification

- LED: Cree XHP35 HD
- Input: DC2.75V-6.00V
- Output: max 1800 lumen
- Reflector: precise metal filmed
- Glass: filmed mineral glass

- Material : HA-III military hard-anodized finish aluminum alloy
- Housing: Premium Type III hard-anodized anti-abrasive finish of black
- Switch: Side Switch and tail switch
- Powered: 1*18650 battery or 2*CR123A
- Size: Ø 1.44 inch/ Ø36.5mm, housing: Ø 1.1 inch /Ø28mm, Length: 6.26 inch/159mm
- Weight: 6.06 Ounces/169.8g (exclude battery)



WeChat



Website

ShenZhen Fitorch Electronics Technology Co., Ltd
Office Address:6F, Longshen Commercial Building
Dalang St, Longhua new district
ShenZhen City, China
Tel: +86-755-2101-3606
Web: www.fitorchworld.com
E-mail: Info@fitorchworld.com



Manual

- Battery Load:** Insert the 1*18650 battery or 2*CR123A as illustrated.
- Tail Cap Tactical Switch Lock/Unlock**
Twist the outer ring of the tail cap to align the mark of with the dot, lock, backward till the dot aligns with mark of , unlock.
- Side Switch Lock/Unlock:** lock, when power off, press the side switch until torch's LED bulb flickers, quick press the metal side switch in 3 times, unlock and power on(low mode) after power self-detection finished.
- On/Off:** Hold and short press side switch power on, long press off.
- Tail Cap Tactical Action**
Middle tail cap will trigger the turbo mode on in any time no matter the flashlight power on or not, click once turbo mode on, click and thumb release power off.
Press one of the side 2 switches and release, strobe mode will be active, long press and thumb release, strobe will keep working on, short press strobe off.
- Mode change:** when power on, short press the side switch, Turbo-High-Medium-Low-Medium-High-Turbo mode will be changed In cycle, quick press the side switch in twice, Strobe mode will be active, again SOS, then press the side switch once, back to normal illumination mode. when power off, press the side switch 1-3 seconds and hand release, torch will jump to low mode.
- Power detection:** quick tap the side switch in 3

- times, the lamp under the side switch button will blink In Green and Red, one Green blink Indicates 1V, one Red blink Indicates In 0.1V, for Instance, 3.8V, 3 Green blinks and 8 red blinks.
- Location beacon:** when power off, quick press the side switch 4 times, green breathing blink around the side switch will be active, press again back to normal illumination.
- Power recharging:** lift the black rubber cap and connect the USB cable Included to the Micro USB port then Insert another end to the USB outlet as below guide, please note when torch is recharging In USB cable, the lamp will blink In green and finally stay In green or lamp off status when battery full charged (only can use the low mode while recharging, press the side switch, power off).
- Charge mobile devices:** connect the Micro USB port and USB convert OTG kit in the cable Included, then connect the power charge port of mobile devices such as cell phones, the torch can still work in MEDIUM or LOW modes while charging, press the side switch once or twice, power off, meanwhile the lamp will blink In red & green.

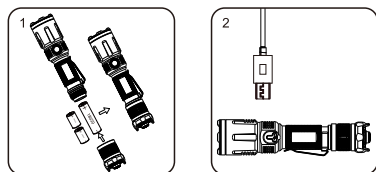

Power Tips

- Low power warning, when voltage less 3.4V, slow red blinks, less 3.0V, quick Red blinks.
- This torch has power auto detection function, if battery capacity less 10% of total, will jump on the lower brightness mode intelligently to avoid the battery over discharge.

Accessories

- Standard: USB Cable, USB OTG kit, removable pocket clip, Lanyard, holster, spare waterproof ring and snap cap
- Optional: battery and recharger

Battery

Rechargeable Li-on battery	1*18650 3.7V
Lithium	2* CR123A 3.0V

Store and maintenance

- Disassembling the sealed head will damage the lights and void the warranty.
- High quality batteries are recommended.
- O-ring will be wear after a Long-term use, change it In included spare one to maintain watertight seal.
- Unload the batteries if assure the torch won't use a bit of long time, then better put It into Inner box.
- Store and keep the torch off fire, statics, steaming and humidity surroundings.
- Clean the body with soft fabric clothing then lubricate In silicon grease per half a year.
- Periodic cleaning of batteries contacts to improve the flashlight performance as dirty contacts cause the lamp flicking, shine intermittently or even fail to illuminate for below factors.
A: Battery need replacing (choose the battery which mentions on this manual)
B: PCB, Spring or other contacts is dirty (clean the contacts In cotton swab In soaked rubbing alcohol)

Warranty

- Any problems happened during 15 days after sold, you can get a new replace one from the local distributors or dealers.
- We provide 60 months(5 years) warranty for free after sold out, over 60 months, only collect the cost of main parts for replacement.